

Controls

REMOTES & ACCESSORIES

Telis Collection.....	2
Remote Operation	3
Hand Held RTS Remotes	4-5
Wall Mount – RTS Transmitters	6
Universally Controlled – RTS Transmitters.....	7
Gate Opener – RTS Transmitters	8
Hand Held – IR Transmitters.....	9
Indoor and Outdoor – RTS Sensors	10-11
Indoor and Outdoor – RTS Receivers	12-13
Lighting & Heating Receivers	14
Indoor Motor IR Receivers.....	15
Accessories for RTS Remotes / Receivers.....	16
Mechanical Switches	17-18
Electronic Switches / Controllers	19
ILT Controllers / Accessories	20
Indoor/Outdoor WT Sensors	21
Motor Controllers – IB and Solo	22-23
Motor Controllers – Compact and IB+	24-25
Motor Controllers – LON and EIB / KNX.....	26-27
Motor Controllers Accessories	28
24V DC Power Supply Selection Chart.....	29
Controllers / Switches – 24V.....	30
Controllers / Power Supplies – 24V	31-32
IR Controllers / Power Supplies	33

TELIS COLLECTION



My button:
You can program the clients favourite position and find it automatically simply by pressing the "my" button of the remote control.

LOUNGE FINISH
For high end sophisticated decor.



SILVER FINISH
Fits naturally within a contemporary decor.



PATIO FINISH
Stylish design for outdoor use.



PURE FINISH
Simple, straight forward and functional.



	TELIS 1 RTS	TELIS 4 RTS	TELIS SOLIRIS RTS	TELIS SOLIRIS 4 RTS	TELIS COMPOSIO RTS
Number of Channels	1	5	1	5	20
Activation/ Deactivation of Sun feature			•	• Only on the 5th channel	•
Venetian Blade Orientation		• Telis 4, Modulis RTS	• Telis Modulis Soliris RTS		
Remote Channel Screen					•
FINISHES					
Pure	•	•	•		
Silver	•	•	• Telis Modulis Soliris RTS		•
Patio	•	•	•	•	
Lounge	•	•	• Telis Modulis Soliris RTS		•

REMOTE OPERATION



Moving the End Product

- >Product Stationary
Press = move to "my" position order
- >Product in motion
Press = stop order
- Press = up order
- Press = down order

Channel Selection (TELIS 4)

- >Successive Presses = channel selection
- >The fifth channel is selected when 4 LEDs flash simultaneously

Activate / Deactivate "Sun" Function (TELIS SOLIRIS)

- >Long Press = activate or deactivate the "sun" function

- Combination button:
- Channel Selection
 - >Successive presses to select the required channel
 - >The fifth channel is selected when all 4 LEDs flash simultaneously
 - Enable/ Disable the "sun" function
 - >Long Press only on the fifth channel

Telis Composio RTS

- Visualisation of created groups (in black) or free groups (in outlined square)
- Group selection name, access the list of the most used channels or all groups
- Low Battery (3x 1.5V type AAA)
- Navigation and selection button
- Help Menu
- Validation button
- Cancel Button
- Press = up order
- >Product Stationary
Press = move to "my" position order
- Press = down order
- >Product in motion
Press = stop order



CONTROLS



Radio Technology Somfy

HAND HELD – RTS REMOTES

PURE	SILVER	LOUNGE	PATIO	TELIS 1 RTS
				One channel radio remote. Allows for the individual or group control of RTS motors / receivers. Somfy Rolling Code. 200m range in an open area and up to 20m range through two reinforced concrete walls. Frequency: 433.42MHz. IP30 (except for Patio: IP44). Supplied with wall mount. Dimensions: 145 x 49 x 22mm. (except for Pure: 134 x 41 x 21mm)
Ref. 1810630	Ref. 1810637 Shock Resistant	Ref. 1810649 Shock Resistant	Ref. 1810642 Shock Resistant Splash Proof	

PURE	SILVER	LOUNGE	PATIO	TELIS 4 RTS
				Five channel radio remote. Allows for the individual and /or group control of RTS motors / receivers. Somfy Rolling Code. 200m range in an open area and up to 20m range through two reinforced concrete walls. Frequency: 433.42MHz. IP30 (except for Patio: IP44). Supplied with wall mount. Dimensions: 145 x 49 x 22mm. (except for Pure: 134 x 41 x 21mm)
Ref. 1810631	Ref. 1810638 Shock Resistant	Ref. 1810651 Shock Resistant	Ref. 1810644 Shock Resistant Splash Proof	

PURE	PATIO	TELIS SOLIRIS RTS
		Sun / Wind radio remote. Allows for the individual or group control of RTS motors / receivers. Used to inhibit the Sun function. Somfy Rolling Code. 200m range in an open area and up to 20m range through two reinforced concrete walls. Frequency: 433.42MHz. IP30 (Pure) IP44 (Patio). Supplied with wall mount. Dimensions Pure: 134 x 41 x 21mm. Dimensions Patio: 145 x 49 x 22mm.
Ref. 1810634	Ref. 1810646 Shock Resistant Splash Proof	

PATIO	TELIS 4 SOLIRIS RTS
	Five channel Sun / Wind radio remote. Allows for the individual and /or group control of RTS motors / receivers. Used to inhibit the Sun function only on the fifth channel. Somfy Rolling Code. 200m range in an open area and up to 20m range through two reinforced concrete walls. Frequency: 433.42MHz. IP44. Supplied with wall mount. Dimensions: 145 x 49 x 22mm.
Ref. 1810648 Shock Resistant Splash Proof	

NOTE: Replacement battery for:
- Telis 1 and Telis 4, 3V type CR2430 (Somfy Part # 9014943)

somfy.

CONTROLS



HAND HELD – RTS REMOTES

SILVER	LOUNGE	TELIS MODULIS SOLIRIS RTS
		<p>Sun / Wind radio remote with Tilt Wheel. Allows for the individual or group control of Modulis RTS Receiver, 4AC Motor Controller RTS card, Integrated DC Receiver or DC RTS Receiver. Somfy Rolling Code. 200m range in an open area and up to 20m range through two reinforced concrete walls.</p> <p>Frequency: 433.42MHz.</p> <p>IP30.</p> <p>Supplied with wall mount.</p> <p>Dimensions: 145 x 49 x 26mm.</p> <p> Suitable only for tilting blade applications.</p>
Ref. 1810666	Ref. 1810665	
Shock Resistant	Shock Resistant	

SILVER	LOUNGE	TELIS 4 MODULIS RTS
		<p>Five channel radio remote with Tilt Wheel. Allows for the individual and /or group control of Modulis RTS Receiver, 4AC Motor Controller RTS card, Integrated DC Receiver or DC RTS Receiver. Somfy Rolling Code. 200m range in an open area and up to 20m range through two reinforced concrete walls.</p> <p>Frequency: 433.42MHz.</p> <p>IP30.</p> <p>Supplied with wall mount.</p> <p>Dimensions: 145 x 49 x 26mm.</p> <p> Suitable only for tilting blade applications.</p>
Ref. 1810663	Ref. 1810664	
Shock Resistant	Shock Resistant	

SILVER	LOUNGE	TELIS COMPOSIO RTS
		<p>Twenty channel radio remote.</p> <p>Allows for the individual or group control of RTS motors / receivers. Sun inhibiting function per channel. Somfy Rolling Code. 200m range in an open area and up to 20m range through two reinforced concrete walls.</p> <p>Frequency: 433.42MHz.</p> <p>IP30.</p> <p>Supplied with wall mount.</p> <p>Dimensions: 174 x 55 x 26mm.</p>
Ref. 1810698	Ref. 1810699	

SILVER	LOUNGE	IMPRESARIO CHRONIS RTS
		<p>Transmits programmable daily functions that can take place at a preset time or based on sun conditions. Memory for 16 scenarios, with 20 groups. Somfy Rolling code. 200m range in an open area and up to 20m range through two reinforced concrete walls.</p> <p>Frequency: 433.42MHz.</p> <p>IP30.</p> <p>Supplied with wall mount.</p> <p>Dimensions: 174 x 56 x 26mm.</p> <p>*Specific training is recommended in order to utilise this product.</p>
Ref. 1810701	Ref. 1810700	
Training Recommended*	Training Recommended*	

NOTE: Replacement Battery for:

- Telis Modulis, 3V type (Spare Part # 9014943)
- Composio and Impresario 3 x 1.5V Type AAA



CONTROLS



Radio Technology Somfy

WALL MOUNT – RTS TRANSMITTERS

SITUO RTS



One channel wall mount radio transmitter. Allows for the individual or group control of RTS motors / receivers. Somfy Rolling Code. 200m range in an open area and up to 20m range through two reinforced concrete walls.

Frequency: 433.42MHz.

Supplied with wall mount & screws.

Dimensions: 120 x 38.5 x 19mm.

Ref. **1810636**

CENTRALIS RTS



One channel wall mount radio transmitter. Allows for the individual or group control of RTS motors / receivers. Somfy Rolling Code. 200m range in an open area and up to 20m range through two reinforced concrete walls.

Frequency: 433.42MHz.

Supplied with wall mount & screws.

Dimensions: 80 x 80 x 16mm.

Ref. **1810090**

SL7077 – HIGH POWER TRANSMITTER



One channel wall mount radio transmitter. Allows for the individual or group control of RTS motors / receivers. Somfy Rolling Code. 400m range in an open area and up to 40m range through two reinforced concrete walls.

Frequency: 433.42MHz.

Supplied with wall mount & screws.

Dimensions: 135 x 80 x 48mm.

Ref. **1810091**

†Longer Range

CHRONIS RTS



One channel wall mount radio transmitter with timer function and manual operation. Allows for the individual or group control of RTS motors / receivers. Somfy Rolling Code. 200m range in an open area and up to 20m range through two reinforced concrete walls.

Frequency: 433.42MHz.

Supplied with wall mount & screws.

Dimensions: 80 x 80 x 27mm.

Ref. **1805040**

NOTE: Replacement battery for:

- Situø, Centralis RTS and SL7077, 3V type CR2430 (Somfy Part # 9014943)
- Chronis RTS 3 x 1.5 type AAA

†Transmission Range increased – 400 metres in open area

somfy.

CONTROLS



Radio Technology Somfy

UNIVERSALLY CONTROLLED – RTS TRANSMITTERS

BUSLINE TRANSMITTER



One channel radio transmitter with volt free contact for integration to a BMS (Building Management System) or other third party device. Allows for the individual or group control of RTS motors / receivers. Somfy Rolling Code. 200m range in an open area and up to 20m range through two reinforced concrete walls.

Frequency: 433.42MHz.

Supplied as flush mount.

Dimensions: 80 x 80 x 45mm.

Ref. **1810334**

UNIVERSAL RTS INTERFACE



Sixteen channel radio transmitter, with RS232 / RS485 or IR control. Allows for the individual or group control of RTS motors / receivers. Somfy Rolling Code. Up to 20m range in an open area.

Frequency: 433.42MHz.

Supplied with power supply.

Dimensions: 76 x 101 x 35mm.

Ref. **1810872**

***Reduced Range**

*Transmission Range reduced – 20 metres in open area

somfy.

CONTROLS



Radio Technology Somfy

GATE OPENER – RTS TRANSMITTERS

WALL MOUNTED RTS CONTROL UNIT



Two channel radio remote, wall mounted. Allows for the individual or group control of RTS Gate Opener products. Somfy Rolling Code. Up to 30m[†] range in an open area.

Frequency: 433.42MHz.

IP54.

Supplied with wall mount & screws.

Dimensions: 105 x 75 x 25mm.

Ref. **1841027**

*Range Compatible

RTS KEYPAD



Two channel radio keypad with security function 4, 5 or 6 digit programmable code. Allows for the individual or group control of RTS Gate Opener products. Somfy Rolling Code. Up to 30m[†] range in an open area.

Frequency: 433.42MHz.

IP54.

Supplied with wall mount & screws.

Dimensions: 105 x 75 x 25mm.

Ref. **1841030**

*Range Compatible

KEYTIS NS2 RTS



Two channel radio remote, slim keyring size. Allows for the individual and / or group control of RTS Gate Opener products. Somfy Rolling Code. Up to 30m[†] range in an open area.

Frequency: 433.42MHz.

IP40.

Supplied with coloured clips.

Dimensions: 69 x 41.5 x 13.7mm.

Ref. **1841026**

*Range Compatible

KEYTIS NS4 RTS



Four channel radio remote with security function, slim keyring size. Allows for the individual and / or group control of RTS Gate Opener products. Somfy Rolling Code. Up to 30m[†] range in an open area.

Frequency: 433.42MHz.

IP40.

Supplied with coloured clips.

Dimensions: 84 x 43 x 16mm.

Ref. **1841025**

*Range Compatible

KEYGO 4 RTS



Four channel radio remote, slim keyring size. Allows for the individual and / or group control of RTS Gate Opener products. Somfy Rolling Code. Up to 30m[†] range in an open area.

Frequency: 433.42MHz.

IP30.

Supplied with coloured buttons.

Dimensions: 35.5 x 61 x 14mm.

Ref. **1841064**

*Range Compatible

NOTE: Replacement batteries for:

- Wall Mounted RTS Control Unit, Keytis 2, Keytis 4 and Keygo. 3V Type CR2430 (Somfy Part # 9014943).
- RTS Keypad 3V Type CR2450 (Somfy Part # 9014944).

*Compatible with existing RTS range of Motors & Receivers (limited functionality)

†Transmission range differs on these products, take note!

somfy.

CONTROLS



HAND HELD – IR TRANSMITTERS

IRT 103 INFRARED REMOTE



Single channel infrared remote. Allows for IR control of Somfy products utilising an IR receiver. 7m range.

IP30.

Dimensions: 110 x 35 x 15mm.

Ref. **1870011**

IRT 803 INFRARED REMOTE



Eight channel infrared remote. Allows for IR control of Somfy products utilising a suitable multi-channel IR receiver. 7m range.

IP20.

Dimensions: 180 x 45 x 30mm.

Ref. **1870010**

NOTE: Replacement battery for:
- IRT 103 & IRT 803, 2 x 1.5V type AAA.

somfy.

SENSORS

Available in Q4 2009

INDOOR

SUNIS INDOOR WIREFREE SENSOR



Radio sensor that will automatically control an external blind / shutter based on a preset amount of sunlight. Not suitable for folding arm or drop arm awnings. Somfy Rolling Code. 200m range in an open area and 20m range through two reinforced concrete walls.

Frequency: 433.42MHz.

IP31.

Supplied with suction cup mount.

Dimensions: Ø55 x 23mm (not including suction cup mount)

Ref. 9013707

THERMOSUNIS INDOOR WIREFREE SENSOR



Radio sensor that will automatically control a blind, shutter or venetian based on a preset amount of sunlight and inside temperature. Not suitable for folding arm or drop arm awnings. Somfy Rolling Code. 200m range in an open area and 20m range through two reinforced concrete walls.

Frequency: 433.42MHz.

IP31.

Supplied with suction cup mount.

Dimensions: Ø55 x 23mm (not including suction cup mount)

Ref. 9013708

NOTE: Replacement batteries for:

- Sunis Indoor & Thermosunis Indoor.



3V Type CR2430 (Somfy Part # 9014943).

somfy.

SENSORS



OUTDOOR

White	Cream	Black	EOLIS 3D
			<p>Radio sensor that will automatically retract a folding arm awning based on wind vibrations through the load bar. Must only be used on a Folding Arm Awning. Battery powered. Compatible with Altus RTS, Orea RTS, CSI RTS and the Universal Receiver.</p> <p>Somfy Rolling Code. 50m range in an open area.</p> <p>Frequency: 433.42MHz.</p> <p>IP44.</p> <p>Supplied with fixing adhesive.</p> <p>Dimensions: 153 x 38 x 25mm.</p>
Ref. 9014400	Ref. 9013809	Ref. 9013847	

EOLIS RTS SENSOR



Radio sensor that will automatically retract a screen / awning based on wind speed. Compatible with Altus RTS, Orea RTS, CSI RTS, Modulis Receiver and the Universal Receiver. Somfy Rolling Code. 200m range in an open area and 20m range through two reinforced concrete walls.

Frequency: 433.42MHz.

IP34.

Supplied with wall mount & screws.

Dimensions: 160 x 236 x 25mm.

Ref. **1816068**

SOLIRIS RTS SENSOR*



Radio sensor that will automatically retract a screen / awning based on wind speed and extend / retract based on a preset amount of sunlight. Compatible with Altus RTS, Orea RTS, CSI RTS, Modulis Receiver and the Universal Receiver. Somfy Rolling Code. 200m range in an open area and 20m range through two reinforced concrete walls.

Frequency: 433.42MHz.

IP34.

Supplied with wall mount & screws.

Dimensions: 160 x 236 x 25mm.

Ref. **1818212**

SUNIS RTS SENSOR*



Radio sensor that will automatically extend a screen / awning based on a preset amount of sunlight. Powered connection not required. Compatible with Altus RTS, Orea RTS, CSI RTS, Modulis Receiver and the Universal Receiver. Somfy Rolling Code. 200m range in an open area and 20m range through two reinforced concrete walls.

Frequency: 433.42MHz.

IP44.

Supplied with wall mount & screws.

Dimensions: Ø100 x 50mm.

Ref. **9013075**

NOTE: Replacement battery for:
- Eolis 3D RTS 2 x 1.5V type AAA.

*Must be used in conjunction with a Soliris Remote to enable Sun function



RECEIVERS



INDOOR RTS RECEIVERS

CENTRALIS INDOOR RECEIVER*



Indoor radio receiver for connection to a standard motor allowing use via an RTS transmitter. Compatible with standard 230V motors. Visual motor programming feedback.

Frequency: 433.42MHz.

IP30.

Supplied as flush mount.

Dimensions: 80 x 80 x 45mm.

Ref. **1810096**

CENTRALIS INDOOR RECEIVER RTS VB*†



Indoor radio receiver with tilt function for connection to a standard motor allowing use via an RTS transmitter. Compatible with standard 230V motors. Visual motor programming feedback.

Frequency: 433.42MHz.

IP30.

Supplied as flush mount.

Dimensions: 80 x 80 x 45mm.

Ref. **1810110**

CENTRALIS UNO RTS*



Indoor radio receiver with manual on-board control for connection to a standard motor allowing use via an RTS transmitter. Compatible with standard 230V motors. Visual motor programming feedback.

Frequency: 433.42MHz.

IP40.

Supplied as flush mount.

Dimensions: 80 x 80 x 50mm.

Ref. **1810217**

DRY CONTACT RECEIVER*



One channel radio receiver with volt free contacts for integration to a BMS (Building Management System) or other third party device.

Frequency: 433.42MHz.

Supplied as flush mount.

Dimensions: 80 x 80 x 45mm.

Ref. **1810750**

* Not compatible with Sunis RTS, Eolis 3D RTS, Eolis RTS or Soliris RTS Sensors.

† Not compatible with Modulis scroll functionality.

RECEIVERS



Radio Technology Somfy

OUTDOOR RTS RECEIVERS

UNIVERSAL SLIM RECEIVER RTS CABLE*



Outdoor slimline radio receiver for connection to a standard motor allowing use via an RTS transmitter and RTS sensor. Supplied with bare cable either end. Compatible only with standard 230V motors.

Frequency: 433.42MHz.

IP54.

Compact high index protection housing.

Dimensions: 130 x 32 x 33mm.

Ref. **1810783**

Sensor Compatible

MODULIS SLIM RECEIVER RTS CABLE*



Outdoor radio receiver with Modulis scroll functionality for connection to a standard motor allowing use via an RTS transmitter and RTS sensor. Compatible only with standard 230V motors.

Frequency: 433.42MHz.

IP54.

Compact high index protection housing.

Dimensions: 130 x 32 x 33mm.

Ref. **1810806**

Sensor Compatible

UNIVERSAL SLIM RECEIVER PLUG*



Outdoor slimline radio receiver for connection to a standard motor allowing use via an RTS transmitter and RTS sensor. Supplied with integrated Hirschmann connectors. Compatible only with standard 230V motors.

Frequency: 433.42MHz.

IP54.

Compact high index protection housing.

Dimensions: 130 x 32 x 33mm.

Ref. **1810784**

Sensor Compatible

MODULIS SLIM RECEIVER RTS PLUG*



Outdoor radio receiver with Modulis scroll functionality for connection to a standard motor allowing use via an RTS transmitter and RTS sensor. Supplied with integrated Hirschmann connectors. Compatible only with standard 230V motors.

Frequency: 433.42MHz.

IP54.

Compact high index protection housing.

Dimensions: 130 x 32 x 33mm.

Ref. **1810802**

Sensor Compatible

UNIVERSAL RECEIVER RTS



Outdoor radio receiver for connection to a standard motor allowing use via an RTS transmitter and RTS sensor. Compatible only with standard 230V motors.

Frequency: 433.42MHz.

IP55.

Supplied with wall mount and screws.

Dimensions: 110 x 110 x 40mm.

Ref. **1810624**

Sensor Compatible

HIRSCHMANN CONNECTOR FOR SUPPLY (BLACK)



Connector: 3 terminals + earth

IP45 rating

Weight: 30g

Ref. **9686064**

HIRSCHMANN CONNECTOR FOR MOTOR (BLACK)



Connector: 3 terminals + earth

IP45 rating

Weight: 30g

Ref. **9686065**

*Not compatible with Rodeo or Linkeo motors.

somfy

RECEIVERS



Radio Technology Somfy

LIGHTING & HEATING RECEIVERS

INDOOR LIGHTING RECEIVER RTS



Indoor radio receiver for connection to a standard light allowing use via an RTS transmitter. Can control virtually any bulb type.

Frequency: 433.42MHz.

IP30.

500W max load.

Dimensions: 80 x 80 x 45mm.

Ref. **1810165**

HEATING RECEIVER RTS



Radio receiver for controlling a heater via an RTS transmitter. Can also control the power to any other device up to max load.

Frequency: 433.42MHz.

IP54.

2000W max load.

Dimensions: 166.5 x 38 x 28.6mm.
(not including cable).

Ref. **1822097**

OUTDOOR LIGHTING RECEIVER RTS



Outdoor radio receiver for connection to a standard light allowing use via an RTS transmitter. Can control virtually any bulb type.

Frequency: 433.42MHz.

IP55.

500W max load.

Dimensions: 110 x 110 x 40mm.

Ref. **1810628**

LIGHTING DIMMER RECEIVER RTS



Radio receiver for dimming a standard light via the Modulis scroll functionality. Can control any dimmable bulb type.

Frequency: 433.42MHz.

IP54.

300W max load.

Dimensions: 40 x 52.7 x 24.7mm.

Ref. **9014281**

Modulis Compatible

RECEIVERS



IR RECEIVERS

IR RECEIVER FOR AC MOTORS



Indoor Infrared receiver with tilt function for connection to a standard motor allowing use via an IR transmitter. Dry contact switch input also built-in. Compatible only with standard 230V motors. Suitable for use with IRT 103, IRT 803.

IP40.

Dimensions: 135 x 120 x 42mm.

Ref. **1860000**

IR3 INFRARED SENSOR



Infrared eye for use with the IR Receiver for AC motors. 2.5m cable supplied.

IP30.

Supplied white in colour.

Dimensions: 47 x 43 x 34mm.

Ref. **9154186**

ACCESSORIES

FOR RTS REMOTES /RECEIVERS

BATTERY LITHIUM 3V CR2430



Replacement battery for Telis Range, Situo, Centralis RTS, SL7077, Keytis Range, Keygo, Wall Mounted RTS Controller, Sunis Indoor and Thermosunis.
Voltage: 3V.
Expected Life: 2-4 years.
(depending on frequency of use).

Ref. **9014943**

SURFACE BOX FOR CENTRALIS INDOOR



Surface mount box for Centralis Indoor RTS, Centralis Indoor RTS VB, Busline Transmitter, Dry Contact Receiver and Indoor Lighting Receiver.
Use when a recess is not available for mounting.
Dimensions: 84 x 84 x 44mm.

Ref. **9154122**

BATTERY LITHIUM 3V CR2450



Replacement battery for an RTS Keypad.
Voltage: 3V.
Expected Life: 2-4 years.
(depending on frequency of use).

Ref. **9014944**

SURFACE BOX FOR INTEO

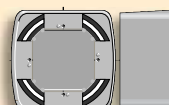

Surface mount box for Inteo items. Suitable for Centralis UNO RTS. Use when a recess is not available for mounting.
Dimensions: 91 x 89.5 x 45mm.

Ref. **9102004**

TABLE SUPPORT



Hemi-Spherical table holder for RTS remote range. Suitable for Telis Silver, Telis Lounge, Telis Patio and Modulis variants. Semi transparent.
Dimensions: ø80 x 30mm.

Ref. **9014572**

MECHANICAL SWITCHES

WIRED TECHNOLOGY™



FOR WT MOTORS

STANDARD



Ref. **1800191**

MOMENTARY



Ref. **1800012**

5 POSITION



Ref. **1800002**

INIS UNO

A single control switch for a 230V AC motor. Available as a standard lock in (fixed) switch, momentary (spring loaded) or 5 position (spring and fixed).

Colour: White & grey.

Max Current: 6A.

Supplied as wall mount.

Dimensions: 80 x 80 x 42mm.

STANDARD



Ref. **1800192**

MOMENTARY



Ref. **1800025**

5 POSITION



Ref. **1800001**

INIS DUO

A dual control switch for two 230V AC motors. Available as a standard lock in (fixed) switch, momentary (spring loaded) or 5 position (spring and fixed).

Colour: White & grey.

Max Current: 6A per switch.

Supplied as wall mount.

Dimensions: 80 x 80 x 42mm.

SURFACE BOX FOR INTEO

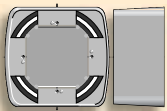

Ref. **9102004**

Surface mount box for Inteo items. Suitable for Inis UNO and Inis DUO. Use when a recess is not available for mounting.

Dimensions: 91 x 89.5 x 45mm.

AUSTRALIAN PLATE FOR INIS UNO & DUO



Ref. **9011637**

Flush mounting suitable for Inis Uno and Inis Duo.

Dimensions: 80 x 120mm.

AUSTRALIAN PLATE FOR INTEO



Ref. **9011636**

Flush mounting suitable for Inteo range items.

Dimensions: 80 x 120mm.

MECHANICAL SWITCHES

WIRED TECHNOLOGY™



FOR WT MOTORS

KEY SWITCH SURFACE MOUNTED



SPRING
LOADED
IN BOTH
DIRECTIONS

Ref. **1841036**



SPRING
LOADED
DOWN,
FIXED IN UP
DIRECTIONS

Ref. **1850039**

A single control key switch for an AC motor. Available as a spring operation in both "up" and "down" directions or as a spring operation for "down" and fixed operation for the "up" direction.

Colour: Grey.

Max Current: 10A.

Weather and burglar proof.

Dimensions: 81 x 71 x 75mm.

KEY SWITCH FLUSH MOUNTED



SPRING
LOADED
IN BOTH
DIRECTIONS

Ref. **1850048**



SPRING
LOADED
DOWN,
FIXED IN UP
DIRECTIONS

Ref. **1800138**

A single control key switch for an AC motor. Available as a spring operation in both "up" and "down" directions or as a spring operation for "down" and fixed operation for the "up" direction.

Colour: Stainless Steel finish.

Max Current: 10A.

Weather and burglar proof.

Dimensions: 110 x 100 x 77mm.

BLANK KEY



Ref. **9660285**

Blank key suitable for key switches:

1841036.

1850039.

1850048.

1800138

ELECTRONIC SWITCHES / CONTROLLERS

WIRED TECHNOLOGY™



FOR WT MOTORS

CENTRALIS UNO IB



Used as the main interface controller for a 230V AC motor with a busline input for master control via an IB switch such as the Centralis IB. Two intermediate positions programmable, along with a busline disabling switch.

IP40.

Dimensions: 80 x 80 x 50mm.

Ref. **1810208**

CENTRALIS UNO IB VB



Used as the main interface controller for a 230V AC motor with a busline input for master control via an IB switch such as the Centralis IB. Tilting feature, two intermediate positions programmable, along with a busline disabling switch.

IP40.

Dimensions: 80 x 80 x 50mm.

Ref. **1810019**

CHRONIS UNO



230V AC controller for a single motor with timer function and manual operation. Configurable one up, one down time per day that can differ each day of the week.

IP40.

Dimensions: 80 x 80 x 50mm.

Ref. **1805007**

SOLIRIS UNO



230V AC controller for a single motor with an interface between a sun, wind, thermostat and / or a rain sensor.

IP40.

Dimensions: 80 x 80 x 50mm.

Ref. **1818148**

CHRONIS IB



Busline controller with timer function and manual operation. Can be used as a master controller for an IB setup. Can also be used with any Somfy device that has a Busline input. eg. FTS Box, 4AC Motor Controller, etc. Configurable one up, one down time per day that can differ each day of the week.

IP40.

Dimensions: 80 x 80 x 50mm.

Ref. **1805031**

SOLIRIS IB



Used as a master control for an IB setup as well as an interface unit between a sun, wind, thermostat and / or a rain sensor. Can also be used with any Somfy device that has a Busline input. eg. FTS Box, 4AC Motor Controller, etc.

IP40.

Dimensions: 80 x 80 x 50mm.

Ref. **1818161**

CENTRALIS IB



Used as a master control for an IB setup. Can also be used with any Somfy device that has a Busline input. eg. FTS Box, 4AC Motor Controller, etc.

IP40.

Dimensions: 81 x 81 x 28mm.

Ref. **1810094**

EOLIS BOX



A 230V AC wind controller interface unit mounted in a splashproof box suitable for outdoor mounting. IB switch input. A rain sensor can also be used with the addition of a rain control board (see sensors).

IP44.

Dimensions: 150 x 150 x 40mm.

Ref. **1816046**

CONTROLLERS / ACCESSORIES

WIRED TECHNOLOGY™



FOR ILT MOTORS

PHONE PLUG CONNECTOR

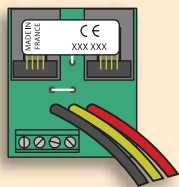

Controller board for interfacing a switched dry contact connection to an ILT motor. Two Phone Plug points can be utilised for motors, an IR eye or attached to other Plug connectors.

IP20.

Supplied with velcro for fixing.

Dimensions: 28 x 37mm.

Ref. **9050200**

ELECTRONIC LIMIT SETTING TOOL



Used to program limits into an ILT motor. Only required on initial setup. LED feedback of cable continuity.

Ref. **9050280**

MULTIPLE PHONE PLUG CONNECTOR

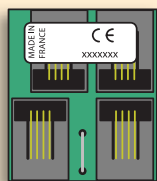

Controller board for connecting multiple ILT motors or switches together. Combinations of connections can be used, eg. 1 ILT motor with 3 switches, 2 ILT motors with 2 switches, 2 ILT motors 1 switch 1 IR eye, etc.

IP20.

Supplied with velcro for fixing.

Dimensions: 28 x 37mm

Ref. **9050190**

TELEPHONE CABLE

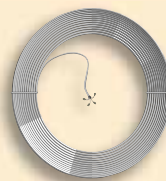

Four wire flat phone cable used to extend ILT cable length.

Sold per metre.

Ref. **9011631**

INDIVIDUAL & GROUP PHONE PLUG CONNECTOR

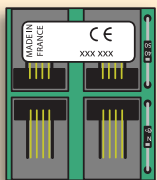

Controller board for individual and master bus switching to an ILT motor. Combinations of Individual and Group connectors can be used with other modules for master switching with individual operation via one or more switches of varying types.

IP20.

Supplied with velcro for fixing.

Dimensions: 28 x 37mm.

Ref. **1860014**

CRIMPING TOOL

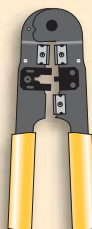

Hand tool for crimping RJ9 connectors to flat four core telephone cable.

Ref. **9685126**

IR3 ILT INFRARED SENSOR



Infrared eye for use with ILT motors and Animeo IR Card. 2.5m cable supplied. Not suitable for use with IRT 803.

IP30.

Supplied white in colour.

Dimensions: 47 x 43 x 34mm.

Ref. **9154205**

MALE PHONE PLUG



Use with 9011631.

Sold in bags of 30.

Ref. **9685127**

SENSORS

WIRED TECHNOLOGY™



FOR WT MOTORS

EOLIS SENSOR



Wind sensor for use with Soliris IB, Soliris UNO and Eolis Box controllers. Measures horizontal wind speed (km/h). Only one sensor can be connected back to the control unit. Up to seven control boxes can be connected to the one sensor.

IP33.

Dimensions: 160 x 236 x 115mm.

Ref. **9101480**

RAIN SENSOR CONTROL BOARD

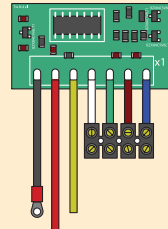

Rain sensor control board for use with a Rain sensor when utilising an Eolis Box.

Ref. **9008108**

SOLIRIS SENSOR



Combined sun and wind sensor for use with Soliris IB & Soliris UNO controllers. Measures 360° sunlight intensity (kLux) and the horizontal wind speed (km/h). Only one sensor can be connected back to the control unit.

IP33.

Dimensions: 160 x 236 x 115mm.

Ref. **9101474**

RAIN SENSOR



Rain sensor for use with Soliris IB, Soliris UNO, Eolis Box (when using the Rain Control Board) and any other volt free inputs / controllers. Heated element to prevent false operation via frost, sleet etc. Mounting: must be pointed 15° in the downward angle.

IP65.

Dimensions: 160 x 70 x 35mm.

Ref. **9705588**

SOLIRIS SUN SENSOR



Sun sensor for use with Soliris IB & Soliris UNO controllers. Measures sunlight intensity (kLux). Only one sensor can be connected back to the control unit. Note: similar variants of this sensor exist. No compatibility between older sensors and / or older controllers.

IP43.

Dimensions: 74.2 x 34.2 x 47mm.

Ref. **9154217**

THERMOSTAT



Thermostat for use with Soliris IB & Soliris UNO, also suitable for any other volt free inputs / controllers. When the temperature drops below the adjustable threshold the controller will issue a retract command to the screen / awning when used in conjunction with a soliris controller.

IP30.

Dimensions: 74 x 74 x 26mm.

Ref. **9709808**

MOTOR CONTROLLERS



FOR WT MOTORS

CD4

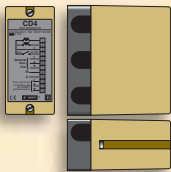

Individual control unit for an AC motor. Accepts volt free switching on Master and Individual bus and will run the motor for 3 mins after a momentary switch closure. Switch inputs can be parallel wired to multiple CD4 controllers to a max length of 1000m.

IP40.

Dimensions: 112 x 52 x 106mm.

Ref. **1810070**

THREE MOTOR GROUP CONTROLLER



Group control unit, allowing up to three motors to be connected via a single controller /switch. No individual control of the connected motors is possible. The Three Motor Group Controller cannot be utilised with a standard fixed position switch, an interlocked / momentary switch is required.

IP40.

Dimensions: 112 x 52 x 106mm.

Ref. **1810054**

FOUR MOTOR GROUP CONTROLLER



Group control unit, allowing up to four motors to be connected via a single controller /switch. No individual control of the connected motors is possible. The four Motor Group Controller cannot be utilised with a standard fixed position switch, an interlocked / momentary switch is required.

IP40.

Dimensions: 150 x 75 x 105mm.

Ref. **1810058**

MOTOR CONTROLLERS



FOR WT MOTORS

SOLO 1 ZONE CONTROLLER



Single Zone wall mounted control unit for Motor Controllers. The controller is compatible with the IB protocol for building / façade management. Graphical interface for sensor readings. Can be used in conjunction with Animeo IB+ Motor Controllers.

IP20
Dimensions: 225 x 149 x 49mm

Ref. **1860143**

Training Recommended*

*Specific training is recommended in order to utilise this product.

SOLO 2 ZONE CONTROLLER



Two Zone wall mounted control unit for Motor Controllers. The controller is compatible with the IB protocol for building / façade management. Graphical interface for sensor readings. Can be used in conjunction with Animeo IB+ Motor Controllers.

IP20
Dimensions: 225 x 149 x 49mm

Ref. **1860144**

Training Recommended*

*Specific training is recommended in order to utilise this product.

MOTOR CONTROLLERS

Compact

FOR WT MOTORS

COMPACT 4 ZONE BUILDING CONTROLLER



4 Zone control unit for Motor Controllers. The controller is compatible with the IB+ protocol for building / façade management. Multiple sun / wind inputs and zone set thresholds. Used in conjunction with Animeo IB+ Motor Controllers. Din-rail mounted.

IP20
Dimensions: 210 x 90 x 61mm

Ref. **1822189**

Training Recommended*

*Specific training is recommended in order to utilise this product.

COMPACT OPERATING INTERFACE



GUI control unit for Compact Building Controller. Used in conjunction with the 4 zone Building Controller to set values and adjust thresholds rather than utilise a PC. Password protected for wall mount security. Can be removed after commissioning.

IP20
Dimensions: 130 x 180 x 200mm

Ref. **9013219**

Training Recommended*

*Specific training is recommended in order to utilise this product.

MOTOR CONTROLLERS



FOR WT MOTORS

1AC MOTOR CONTROLLER WM



Individual control unit for an AC motor. Accepts volt free switching on master and individual bus. Master switch inputs can be parallel wired up to multiple 1AC controllers to a max length of 1000m. The controller is compatible with Somfy's IB+ protocol for façade management. Venetian (US, EU) and screens mode selectable.

Dimensions: 90 x 180 x 45mm.

Ref. **1860121**

4AC MOTOR CONTROLLER WM



Control unit for four AC motors. Accepts volt free switching on master and individual bus. Master switch inputs can be parallel wired up to multiple 4AC controllers to a max length of 1000m. The controller is compatible with Somfy's IB+ protocol for façade management. Venetian (US, EU) and screens mode selectable. Slot for RTS or IR card upgrade.

IP20.

Dimensions: 255 x 180 x 61mm.

Ref. **1860049**

1AC MOTOR CONTROLLER PCB



Individual control unit for an AC motor. Accepts volt free switching on master and individual bus. Master switch inputs can be parallel wired up to multiple 1AC controllers to a max length of 1000m. The controller is compatible with Somfy's IB+ protocol for façade management. Venetian (US, EU) and screens mode selectable. Circuit board only.

Use with: 9008049.

Dimensions: 65 x 105 x 20mm.

Ref. **1860122**

4AC MOTOR CONTROLLER DRM



Control unit for four AC motors. Accepts volt free switching on master and individual bus. Master switch inputs can be parallel wired up to multiple 4AC controllers to a max length of 1000m. The controller is compatible with Somfy's IB+ protocol for façade management. Venetian (US, EU) and screens mode selectable.

Slot for RTS or IR card upgrade. DIN Rail version.

IP20.

Dimensions: 210 x 90 x 61mm.

Ref. **1860081**

DIN RAIL ADAPTOR



For use with a 1AC Motor Controller PCB. Suitable for a 35mm DIN rail.

Dimensions: 70 x 105 x 23mm.

Ref. **9008049**

4DC MOTOR CONTROLLER WM



Control unit for four DC motors. Accepts volt free switching on master and individual bus. Master switch inputs can be parallel wired up to multiple 4DC controllers to a max length of 1000m. The controller is compatible with Somfy's IB+ protocol for façade management. Venetian (US, EU) and screens mode selectable. Slot for RTS or IR card upgrade.

IP20.

Use with: 1860093.

Dimensions: 255 x 180 x 61mm.

Ref. **1860085**

4DC/DC-E MOTOR CONTROLLER WM



Control unit for four DC/ DC-E motors. Accepts volt free switching on master and individual bus. Master switch inputs can be parallel wired up to multiple 4DC/ DC-E controllers to a max length of 1000m. The controller is compatible with Somfy's IB+ protocol for façade management. Venetian (US, EU) and screens mode selectable. Slot for RTS or IR card upgrade.

IP20.

Integrated power supply.

Dimensions: 255 x 180 x 61mm.

Ref. **1860087**

MOTOR CONTROLLERS

LONMARK®

FOR WT MOTORS

LON 4AC MOTOR CONTROLLER WM



Control unit for four AC motors. The controller is compatible with the LON protocol for building / façade management. Slot for RTS or IR card upgrade. Can be used in conjunction with Animeo IB+ Motor Controllers.

IP20.

Dimensions: 255 x 180 x 61mm.

Ref. **1860115**

*Professional Product

LON 4AC MOTOR CONTROLLER DRM



Control unit for four AC motors. The controller is compatible with the LON protocol for building / façade management. Slot for RTS or IR card upgrade. Can be used in conjunction with Animeo IB+ Motor Controllers. DIN Rail version.

IP20.

Dimensions: 210 x 90 x 61mm.

Ref. **1860119**

*Professional Product

*A trained integrator is required in order to program/ commission this product.

somfy.

MOTOR CONTROLLERS



FOR WT MOTORS

EIB/KNX 4AC MOTOR CONTROLLER WM



Control unit for four AC motors. The controller is compatible with the EIB / KNX protocol for building / façade management. Slot for RTS or IR card upgrade.
IP20.

Dimensions: 255 x 180 x 61mm.

Ref. **1860114**

*Professional Product

EIB/KNX 4AC MOTOR CONTROLLER WM



Control unit for four AC motors. The controller is compatible with the EIB / KNX protocol for building / façade management. Slot for RTS or IR card upgrade.
DIN Rail version.

IP20.

Dimensions: 210 x 90 x 61mm.

Ref. **1860116**

*Professional Product

*A trained integrator is required in order to program/ commission this product.

somfy.

MOTOR CONTROLLERS

ELECTRONIC ACCESSORIES

RTS CARD



Radio receiver for Animeo's 4AC Motor Controllers, 4DC Motor Controller and 4DC/E Motor Controller. Allows for the use of an RTS transmitter with the Motor Controller. Compatible only with standard WT motors via the Motor Controller. Rolling code.

Frequency: 433.42MHz.
IP20.

Dimensions: 92 x 52 x 27mm.

Ref. **1860105**

Modulis Compatible

IR3 INFRARED SENSOR



Infrared eye for use with ILT motors and Animeo IR Card. 2.5m cable supplied. Not suitable for use with IRT 803.

IP30.

Supplied white in colour.

Dimensions: 47 x 43 x 34mm.

Ref. **9154205**

IR CARD



Infrared receiver for Animeo's 4AC Motor Controller, 4DC Motor Controller and 4DC/E Motor Controller. Allows for the use of an IR transmitter with the Motor Controller. Compatible only with standard WT motors via the Motor Controller.

Frequency: 433.42MHz.
IP20.

Dimensions: 92 x 52 x 27mm.

Ref. **1860098**

ANIMEO SCREWDRIVER

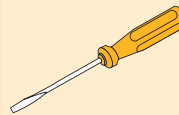

Somfy/ Animeo branded screwdriver designed for use with Animeo range products. 2.5mm flathead.

Supplied yellow in colour.

Dimensions: 0.4 x 2.5 head x 75mm total length.

Ref. **5008587**

24V DC POWER SUPPLY MOTOR SELECTION CHART

The following chart is a guide only.
Refer to the hardware manufacturer for more details.

HOW TO USE THIS SELECTION CHART

- Select the motor desired for the application ('y' axis).
- Select the power supply required ('x' axis).
- Follow the two until they intersect, the maximum number of motors that can be utilised from that one power supply will be shown.
- A safety factor has already been taken into account.

POWER SUPPLY

MOTOR TYPES	Power 1.5DC	GPS100	GPS1020	Power 2.5 DC/DC RTS	ANIMEO Power Supply
LV25-B44 	3	11	11	6	11
LV25-B64 	3	9	9	5	9
LW25-B83 	2	7	7	4	7
LT28-B73 	3	11	11	4	11
Sonessa 30 	1	2	-	1 <small>Not suitable for use with Power 2.5 DC RTS</small>	2
Linkeo 2 DC 	1	6	6	3	5
Linkeo 4 DC 	-	2	2	1	1
Rodeo DC 	2	6	6	3	6

CONTROLLERS / SWITCHES

WIRED TECHNOLOGY™



FOR 24V DC MOTORS

S31 ROCKER SWITCH



Ref. 1870062

DC three position rocker switch for 24V DC WT motors. Used in conjunction with a suitable power supply the motors power will be inverted when a reversal of direction is required.

Max. Number of Motor(s): 6 x LV25-B44 / LW25-B44.
5 x LV25-B64.
4 x LT 28.
4 x LW25-B83.
3 x Linkeo 2.
1 x Linkeo 4.
3 x Rodeo.

S51 ROCKER SWITCH



Ref. 1870061

DC five position rocker switch for 24V DC WT motors. Used in conjunction with a suitable power supply the motors power will be inverted when a reversal of direction is required. Tilting accessed by brief presses.

Max. Number of Motor(s): 6 x LV25-B44 / LW25-B44.
5 x LV25-B64.
4 x LT 28.
4 x LW25-B83.
3 x Linkeo 2.
1 x Linkeo 4.
3 x Rodeo.

CENTRALIS DC IB



Ref. 1810153

DC Inteo style switch for the control of 24V DC WT motors. Busline input for master control via a Centralis IB, suitable 24V power supply required.

Max. Number of Motor(s): 6 x LV25-B44 / LW25-B44.
5 x LV25-B64.
4 x LT 28.
4 x LW25-B83.
3 x Linkeo 2.
1 x Linkeo 4.
3 x Rodeo.
Dimensions: 80 x 80 x 30mm.

WHITE PLATE



Ref. 9137159

Flush mount plate for S31 and S51 rocker switch. Requires a reveal behind mounting surface.

Dimensions: 80 x 80mm.

SURFACE BOX



Ref. 9660135

Surface mount box for S31 and S51 rocker switch.
Dimensions: 86 x 42 x 39mm.

SURFACE BOX FOR INTEO

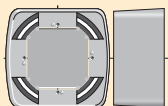

Ref. 9102004

Surface mount box for Inteo items. Suitable for Centralis DC IB. Use when a recess is not available for mounting.

Dimensions: 91 x 89.5 x 45mm.

CONTROLLERS / POWER SUPPLIES



FOR 24V DC MOTORS

POWER 1.5DC



Power supply for 24V DC Somfy devices. Utilise with a suitable DC switch or receiver. Regulated output. LED for power verification.

Nominal Load: 2.7A (intermittent).
IP20.
Dimensions: 110 x 53 x 20mm.

Ref. **1870149**

POWER 2.5DC



Power supply for 24V DC Somfy devices. Utilise with a suitable DC switch or receiver. Regulated output.

Nominal Load: 2.5A (intermittent).
IP20.
Dimensions: 150 x 150 x 50mm.

Ref. **1870031**

GPS 100



Power supply for 24V DC Somfy devices. Utilise with a suitable DC switch or receiver. Regulated output.

Nominal Load: 5A (intermittent).
IP40.
Dimensions: 135 x 120 x 44mm.

Ref. **1870035**

ANIMEO POWER 4.5DC



Power Supply for Animeo's 4DC Motor Controller and other suitably switched 24V DC Somfy Motors. Regulated output.

Nominal Load: 4.5A (intermittent).
IP20.
Dimensions: 130 x 180 x 63mm.

Ref. **1860093**

CONTROLLERS / POWER SUPPLIES



Radio Technology Somfy

FOR 24V DC MOTORS

POWER 2.5DC RTS



Power supply for 24V DC Somfy devices. Allows for the use of an RTS transmitter. Compatible only with standard 24V WT motors via the controller. Rolling code. Regulated output.

Frequency: 433.42MHz.

Nominal Load: 2.5A (intermittent).

IP20.

Dimensions: 150 x 150 x 50mm.

Ref. **1870036**

DC RTS RECEIVER

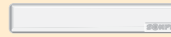

Radio receiver for 24V DC WT motors. Allows for the use of an RTS transmitter. Compatible only with standard 24V WT motors, a suitable power supply is also required. Rolling code.

Frequency: 433.42MHz

IP20.

Dimensions: 150 x 25 x 25mm.

Max. Number of Motors: 2x LV25-B44/ LW25-B44.

2x LV25-B64.

2x LT 28.

2x LW25-B83.

1x Linkeo 2.

1x Rodeo.

Ref. **1870139**

Modulis Compatible

INTEGRATED RECEIVER



Radio receiver for 24V DC WT motors. Allows for the use of an RTS transmitter. Compatible only with standard 24V WT motors, a suitable power supply is also required. Suitable headrail adaptors required for mounting. Rolling code.

Frequency: 433.42MHz.

IP20.

Dimensions: Ø24 x 97mm.

Max. Number of Motors: 2x LV25-B44/ LW25-B44.

2x LV25-B64.

2x LT 28.

2x LW25-B83.

1x Linkeo 2.

1x Rodeo.

Ref. **1870144**

Modulis Compatible

IR CONTROLLERS / POWER SUPPLIES



FOR 24V DC MOTORS

IRS 300



Ref. **1870002**

Integrated infrared eye and controller for 24V WT DC motors. Busline input for master control via a Centralis IB and IR control when utilised with an IRT103 or IRT803. Tilt control available. A suitable 24V power supply is required.

Max. Number of Motors: 3 x LW25-B44 / LW25-B44.
3 x LW25-B64.
3 x LT 28.
3 x LW25-B83.
1 x Linkeo 2.
2 x Rodeo.
Dimensions: 76 x 50 x 32mm.

IR3 INFRARED SENSOR



Ref. **9154186**

Infrared eye for use with the GPS 1020. 2.5m cable supplied.

IP30.
Supplied white in colour.
Dimensions: 47 x 43 x 34mm.

GPS 1020



Ref. **1870059**

Power supply for standard 24V DC Somfy motors. Integrated electronic controller accepting, a volt-free input, infrared eye input and busline input. Tilting feature. Regulated output.

Suitable for use with IRT103, IRT 803.

Nominal Load: 5A (intermittent).
IP40.
Dimensions: 135 x 120 x 44mm.

